

# Information for the WCPFC participants

- **Emergency / Medical Institutions**
- **Restaurants**

# Emergency Exit( → )

## 3F FLOOR PLAN

 EMERGENCY EXIT  
 ELEVATOR

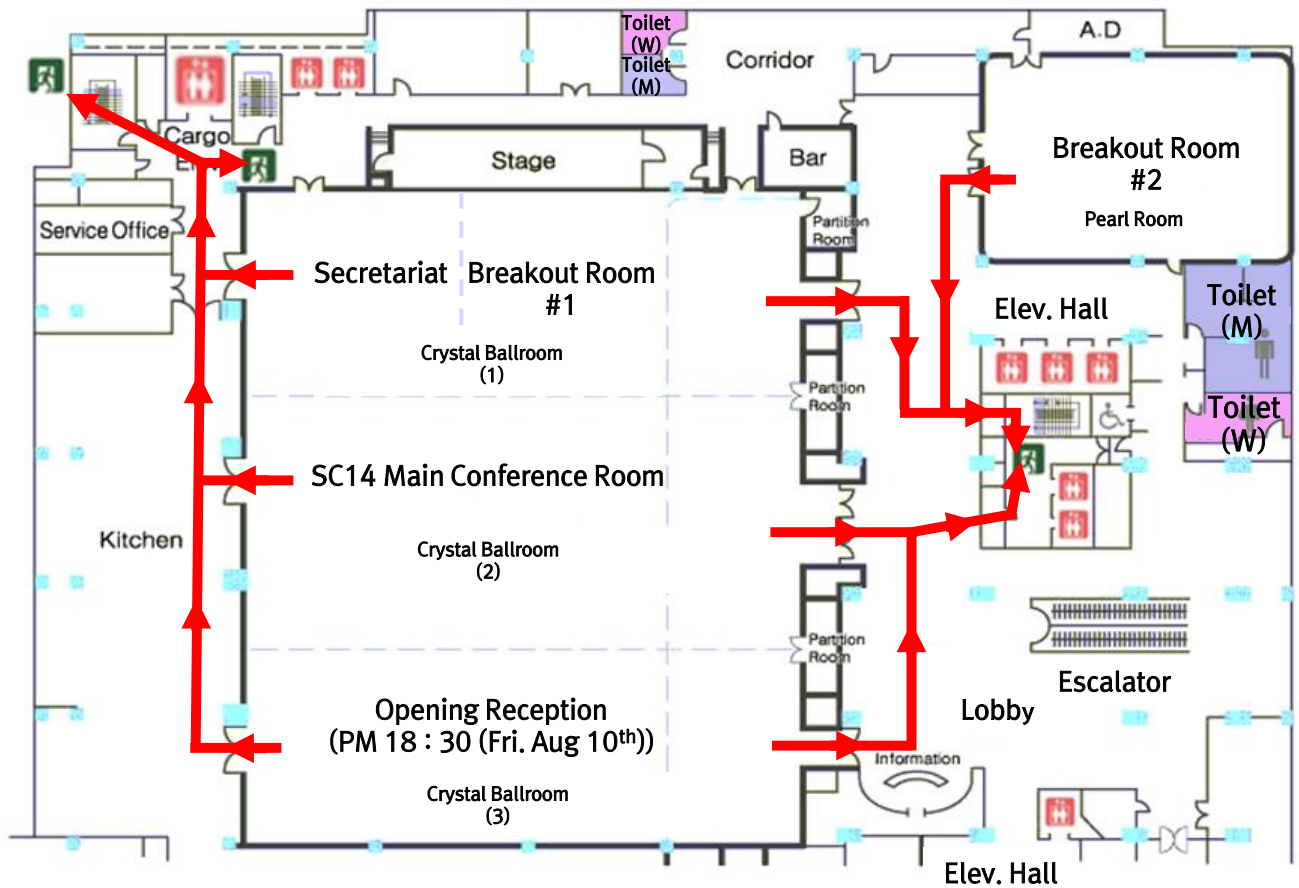

# Emergency / Medical Institutions

## Medical Support Service at BUSAN LOTTE HOTEL

- Nunevit Eye Center: Tel : (051)-810-5678  
14F (Mon to Thu – AM 09:30 ~ PM 19:00 / Fri – AM 09:30 ~ PM 21:00 /  
Sat – AM 09:30 ~ PM 17:00 / Lunch – PM 13:00 ~ PM 14:30)
- DongBo Pharmacy: Tel : (051)-810-4056  
LOTTE Department Store B1  
(Mon to Thu – AM 10:30 ~ PM 20:00 / Fri to Sun – AM 10:30 ~ PM 20:30)
- Secretariat Staff Tel : 010-2638-0918 (Da Som Jo)  
010-4500-8645 (Seung Hwan Lee)

## CHOONHAE HOSPITAL (<http://www.choonhae.or.kr>)

- Tel.: (051)-638-8000
- Address: 873, Beomchon-1 dong, Jin-gu (10min. From LOTTE HOTEL on feet)
- Services in English: N/A (Need an interpreter)
- Mon – AM 09:00 ~ 18:00 / Tue to Fri – 09:00 ~ 17:00 / Sat 09:00 ~ 13:00  
Lunch – PM 12:30 ~ 13:30
- Running 24/7 Emergency Center

## Digital Art Dental Clinic ([www.digitalartdc.com/](http://www.digitalartdc.com/))

- Tel.: (051)-515-8267
- Address: 79, Bujeon-ro, Jin-gu (5 min. from LOTTE HOTEL on feet)
- Services in English: Available
- Mon to Fri – AM 10:00 ~ PM 19:00 / Sat – AM 10:00 ~ PM 16:00

## Gang Internal Medicine Clinic

- Tel.: (051)-817-2334
- Address: 73, Seomyeon-ro, Jin-gu (10 min. from LOTTE HOTEL on feet)
- Services in English: Available
- Mon to Fri – AM 09:00 ~ PM 18:00 / Sat – AM 09:00 ~ PM 13:00

# Korean Traditional Food

- **Soup**



**Samgyetang**

Samgyetang is a variety of guk or Korean soup, which primarily consists of a whole young chicken and Korean ginseng. The dish's name literally translates as "ginseng chicken soup" in English.



**Yukgaejang**

Yukgaejang is a spicy, soup-like Korean dish made from shredded beef with scallions and other ingredients, which are simmered together for a long time. It is a variety of thick soup, which was formerly served in Korean royal court cuisine. It is believed to be healthy and is popular due to its hot and spicy nature.



**Kimchi Jjigae**

Kimchi Jjigae is a variety of Jjigae, or stew-like Korean dish, made with kimchi and other ingredients, such as scallions, onions, diced tofu, pork, and seafood, although pork and seafood are generally not used in the same recipe. It is one of the most common Jjigae in Korea



**Doenjang Jjigae**

Doenjang Jjigae is a variety of Jjigae or stew-like Korean traditional dish, made with Doenjang (Korean soybean paste) and available ingredients such as vegetables, mushrooms, seafood, tofu. It is regarded as one of the representative dishes of food in Korea along with Kimchi Jjigae.



**Gomtang**

Gomtang also called Gomguk, refers to a soup in Korean cuisine made with various beef parts such as ribs, oxtail, brisket, ox's head or ox bones by slow simmering on a low flame. The broth of gomtang tends to have a milky color with a rich and hearty taste.

# Korean Traditional Food

## • Noodle



**Kalguksu**

Kalguksu (literally "knife noodles") is a Korean noodle dish consisting of handmade, knife-cut wheat flour noodles served in a large bowl with broth and other ingredients.



**Kongguksu**

Kongguksu is a popular seasonal (specially summer) Korean noodle dish. It's served in a cold soy milk broth. It consists of noodles made with wheat flour and soup made from ground soybeans.

## • Meat



**Samgyeopsal**

Samgyeopsal is a popular Korean dish. It consists of thick, fatty slices of pork belly meat (similar to uncured bacon). It's usually eaten directly from a grill. It is often dipped into a spicy pepper paste.



**Kalbi**

Kalbi is generally referred to as a variety of grilled dishes in Korean cuisine that is made with marinated beef (or pork) short ribs in a ganjang-based sauce (Korean soy sauce). It's eaten directly from a grill.



**Bulgogi**

Bulgogi is a Korean dish that usually consists of marinated barbecued beef, chicken or pork. It is listed at number 23 on World's 50 most delicious foods readers' poll compiled by CNN Go in 2011

## • Rice



**Bibimbap,  
Dolsot bibimbap**

Bibimbap is served as a bowl of warm white rice topped with NAMUL (sautéed and seasoned vegetables) and GOCHUJAN (chili pepper paste sauce). The ingredients are stirred together thoroughly just before eating.

# Korean Traditional Food

## • Alcohol



Soju

Soju is a distilled beverage native to Korea. Its taste is comparable to vodka, though often slightly sweeter due to sugars added in the manufacturing process. It is usually consumed neat.



Makgeolli

Makgeolli, also known as Makkoli or Makuly(Takju) (and referred to in English as "Korean rice wine"), is an alcoholic beverage native to Korea. It is made from a mixture of wheat and rice, which gives it a milky, off-white color, and sweetness.

## • Street Food



Sundae

Sundae is a Korean dish made generally by boiling or steaming cow or pig's intestines that are stuffed with various ingredients. It is a kind of blood sausage and believed to have been eaten for a long time.



Tteokbokkil

Tteokbokki is a popular Korean snack food which is commonly purchased from street vendors or Pojangmacha. It is a braised dish of sliced rice cake, meat, eggs, and seasoning. Tteokbokki used gochujang, a hot paste made from chilli peppers.



Gimhap

Gimhap is a popular Korean dish made from steamed white rice (bap) and various other ingredients, rolled in gim (sheets of dried laver seaweed) and served in bite-size slices. Gimhap is often eaten during picnics or outdoor events, or as a light lunch, served with danmuji or kimchi.



# Restaurants

\* Refer to the attached map for the location of restaurants



## 1. Songjeong Samdae Gukbap

Address :

29 Seomyeon-ro 68beon-gil, Bujeon-dong, Jin-gu

Tel : (051)-806-5722

Business hour : 24hour



## 2. Gaemijib

Address :

73 Sincheon-daero 62beon-gil, Bujeon-dong, Jin-gu

Tel : (051)-819-8809

Business hour : 24hour



## 3. Gijang Home-made Noodle Soup

Address : 56 Seomyeon-ro, Bujeon 2-dong, Jin-gu

Tel : (051)-806-6832

Business hour : AM 09:00 – PM 09:00



## 4. Seomyeon Gaegeum Milmyeon

Address :

39 Seomyeon-ro 68beon-gil, Bujeon 2-dong, Jin-gu

Tel : (051)-802-0456

Business hour : AM 09:00 – PM 10:00

# Restaurants

\* Refer to the attached map for the location of restaurants



## 5. Namja Gopchang

Address : 187-1 Bujeon 2-dong, Jin-gu

Tel : (051)-816-0204

Business hour : PM 10:00 – AM 04:00



## 6. Matchandeul Wang Sogeumgui

Address : 24-3 Jungang-daero 691beonga-gil,  
Bujeon-dong, Jin-gu

Tel : (051)-808-6088

Business hour : AM 11:00 – AM 03:00



## 7. Hong-Yudan

Address : 524-43 Bujeon-dong, Jin-gu

Tel : (051)-808-4001

Business hour : AM 11:00 – PM 08:00



## 8. 200 Million Man's Grill Dining & Pub

Address : 27-8 Jungang-daero 702beon-gil,  
Bujeon-dong, Jin-gu

Tel : (051)-802-2469

Business hour : PM 04:00 – AM 02:00



# Restaurants

